



- GENERAL NOTES
- G1. DO NOT SCALE THIS DRAWING.
 - G2. ANY DIMENSIONAL DISCREPANCIES SHOULD BE NOTIFIED TO THE ENGINEER IMMEDIATELY.
 - G3. ALL DIMENSIONS ARE IN MILLIMETRES - (mm)
 - G4. ALL LEVELS ARE IN METRES - (m) AND ARE ABOVE ORDNANCE DATUM AT NEWLYN, CORNWALL UNLESS NOTED OTHERWISE.
 - G5. NORTH SHOWN INDICATIVE ONLY
 - G6. THIS DRAWING IS TO BE READ IN CONJUNCTION WITH ALL RELEVANT; SPECIFICATIONS; DRAWINGS; DETAILS AND OTHER DESIGN INFORMATION.
 - G7. ALL DRAWINGS AND WRITTEN MATERIAL CONTAINED WITHIN, CONSTITUTE ORIGINAL AND UNPUBLISHED WORK OF THE ENGINEER AND MAY NOT BE DUPLICATED, USED, REPRODUCED OR DISCLOSED WITHOUT WRITTEN CONSENT OR EXPRESS PERMISSION FROM THE ENGINEER.
 - G8. WHERE THE CONTRACTOR UNDERTAKES OR ENGAGES A THIRD PARTY TO UNDERTAKE TEMPORARY WORKS DESIGN, OR VARIES THE PELL FRISCHMANN DESIGN IN ANY WAY, THEN THE CONTRACTOR WILL TAKE FULL RESPONSIBILITY AND LIABILITY FOR ALL DESIGN ASPECTS, INCLUDING A DESIGN RISK ASSESSMENT. THE CONTRACTOR SHALL INFORM PELL FRISCHMANN OF ANY PROPOSED VARIANCES TO THE DESIGN.

- KEY:
-  3m Shared Use Pathway
 -  Separation Strip
 -  Existing redway

OPTION B Sheet 2

| | | | | | |
|-----|--------------|-----|-----|-----|----------|
| P01 | FOR APPROVAL | AH | BB | - | 18.08.23 |
| REV | DESCRIPTION | DRN | CHK | APP | DATE |

Pell Frischmann
 SUITE 109, PLAZA 668, HITCHIN ROAD, BEDFORDSHIRE LU2 7XH
 Telephone +44 (0)158 232 1222
 Email: pfluton@pellfrischmann.com
 www.pellfrischmann.com

Architect/Client/Contractor
MILTON KEYNES COUNCIL

Project
**MILTON KEYNES
 LOCAL WALKING & CYCLING
 INFRASTRUCTURE PLAN**

Drawing Title
**SCHEME NO.146 (SHEET 2 OF 3)
 FISHERMEAD TO CMK
 FEASIBILITY DRAWING**

Drawing Status **FOR APPROVAL**

| Name | Date | Status Code |
|-------------|----------|--------------|
| Drawn SL | 18.08.23 | S4 |
| Designed SL | 18.08.23 | Scale 1:1000 |
| Eng Chk BB | 18.08.23 | Revision P01 |
| Approved - | - | - |

Drawing No. **106346 - PEF-GA- ZZ - DR - D1 2146-2**

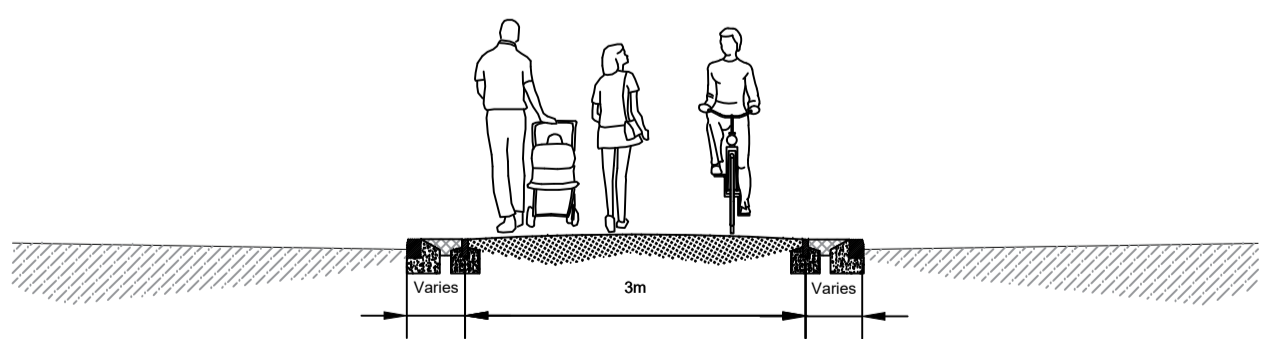
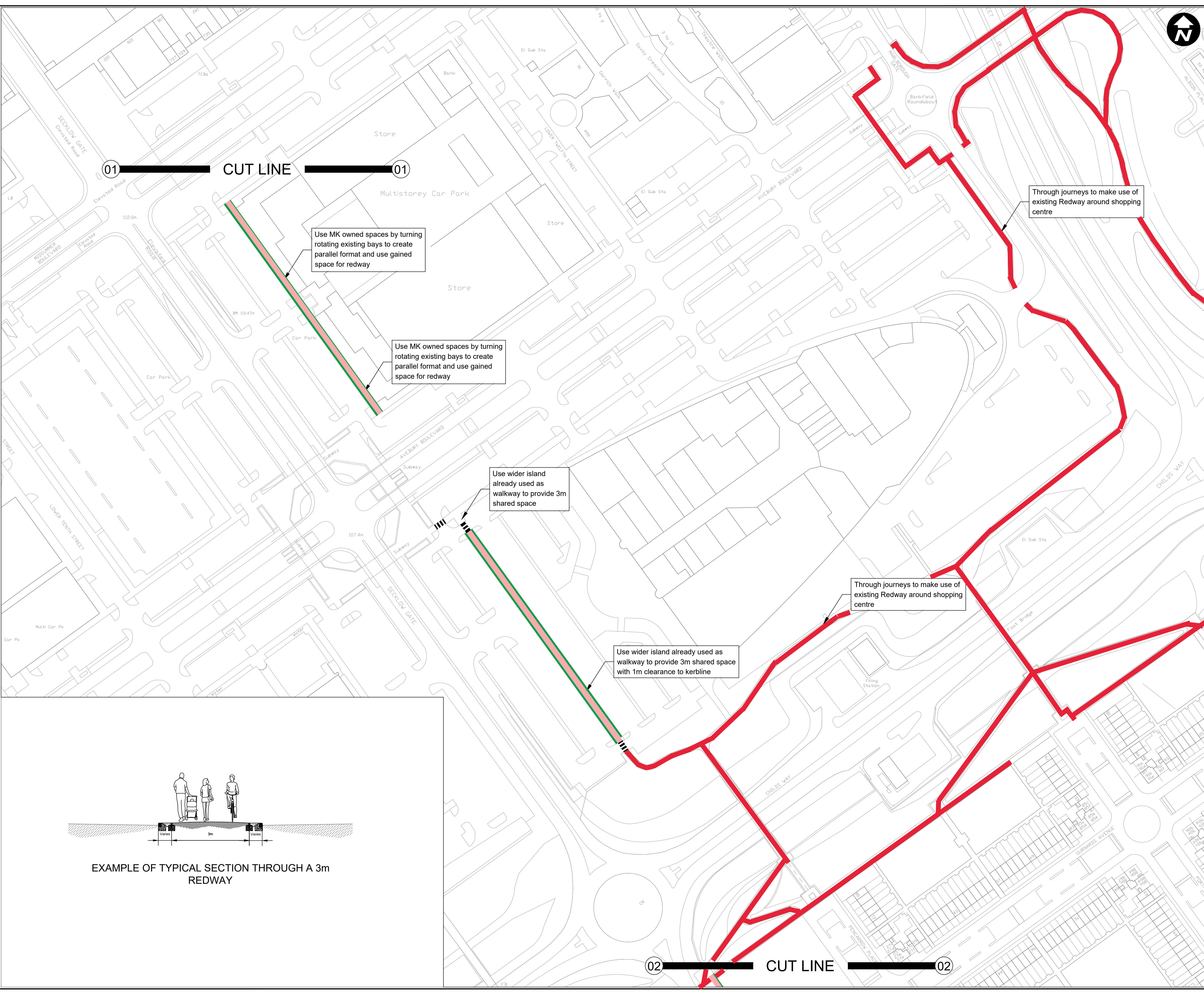

EXAMPLE OF TYPICAL SECTION THROUGH A 3m REDWAY