

LINK 101 - LONGSECTION - CH 000.000M - CH 250.000M
SCALE: H 1:500,V 1:100. DATUM: 63.000

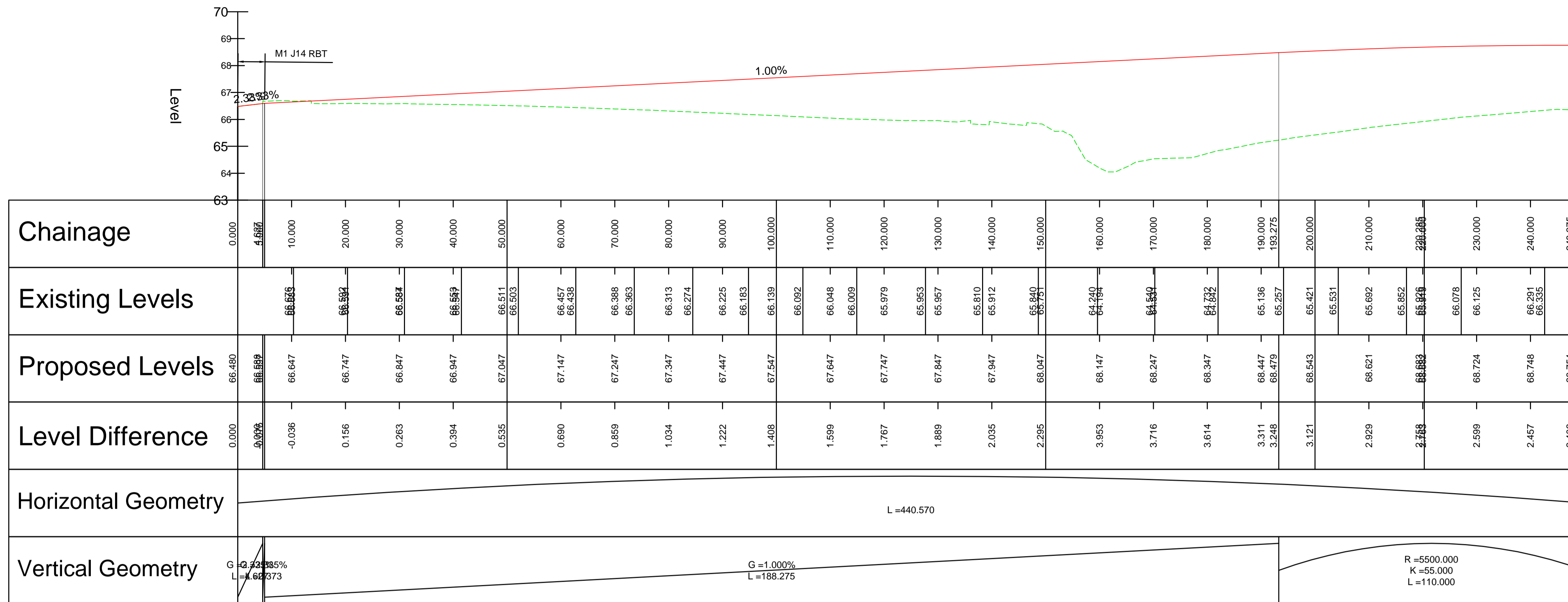

- NOTES:
- ALL DIMENSIONS ARE IN METRES UNLESS OTHERWISE STATED.
 - ALL LEVELS ARE IN METRES ABOVE ORDNANCE DATUM NEWLYN (AOD).
 - THIS DRAWING SHOULD BE READ IN CONJUNCTION WITH ALL RELEVANT DOCUMENTATION, DRAWINGS AND STANDARD DETAILS.
 - THIS DRAWING IS NOT TO BE REPRODUCED IN ANY PART OF FORM WITHOUT PRIOR CONSENT FROM WSP UK LIMITED, ALL COPY RIGHT RESERVED.
 - CONFLICTING INFORMATION SHOWN ON THE ENGINEER'S DRAWINGS OR DISCREPANCIES BETWEEN THE INFORMATION GIVEN BY THE ENGINEER AND THAT PROVIDED BY OTHERS MUST BE REFERRED TO THE ENGINEER BEFORE THE WORKS COMMENCE.

KEY:

— PROPOSED ROAD ALIGNMENT

- - - TOPOGRAPHICAL SURVEY

LINK 101 - LONGSECTION - CH 250.000M - CH 440.570M
SCALE: H 1:500,V 1:100. DATUM: 63.000

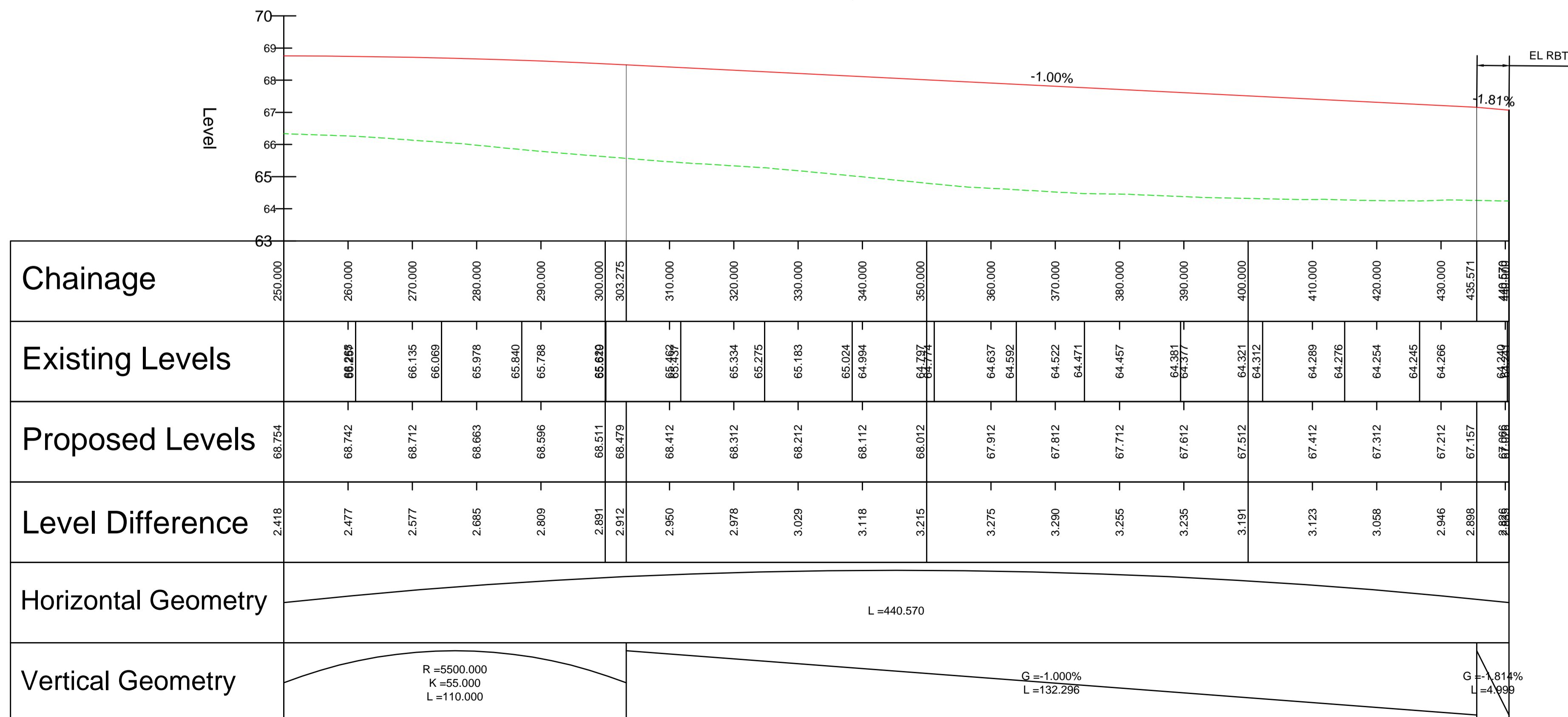

UNTIL TECHNICAL APPROVAL HAS BEEN OBTAINED FROM THE RELEVANT LOCAL AUTHORITIES OR STATUTORY BODIES, IT SHOULD BE UNDERSTOOD THAT ALL DRAWINGS ARE ISSUED AS PRELIMINARY AND NOT FOR CONSTRUCTION. SHOULD THE CONTRACTOR AND / OR EMPLOYER COMMENCE WORK PRIOR TO APPROVAL BEING GIVEN, IT IS ENTIRELY AT THEIR OWN RISK

REV	DATE	BY	DESCRIPTION	CHK	APP
P03	26/03/2021	OPL	MINOR AMENDMENTS FOR PLANNING	ARP	SAP
P02	12/03/2021	OPL	ISSUED FOR PLANNING	ARP	SAP
P01	20/11/2020	DE	FIRST ISSUE	ARP	SAP

DRAWING STATUS: S4 - FOR APPROVAL

Grosvenor House, 2 Grosvenor Square, Southampton, SO15 2BE, UK
T+44 (0) 2380 101 700
wsp.com

CLIENT: BERKELEY ST JAMES

ARCHITECT: JTP / STEPHEN GEORGE AND PARTNERS

SITE/PROJECT: MILTON KEYNES EAST

TITLE: LINK 101 LONG SECTION
CH 000.000m - CH 440.570m

SCALE @ AT:	CHECKED:	APPROVED:
AS SHOWN	ARP	SAP

PROJECT NO:	DESIGNED:	DRAWN:	DATE:
70057521	ARP	GLG	November 20

DRAWING No:	REV:
MKE-WSP-ZZ-ZZ-C-SK-2801	P03

© WSP UK Ltd