

FOR CONTINUATION REFER TO SHEET 5

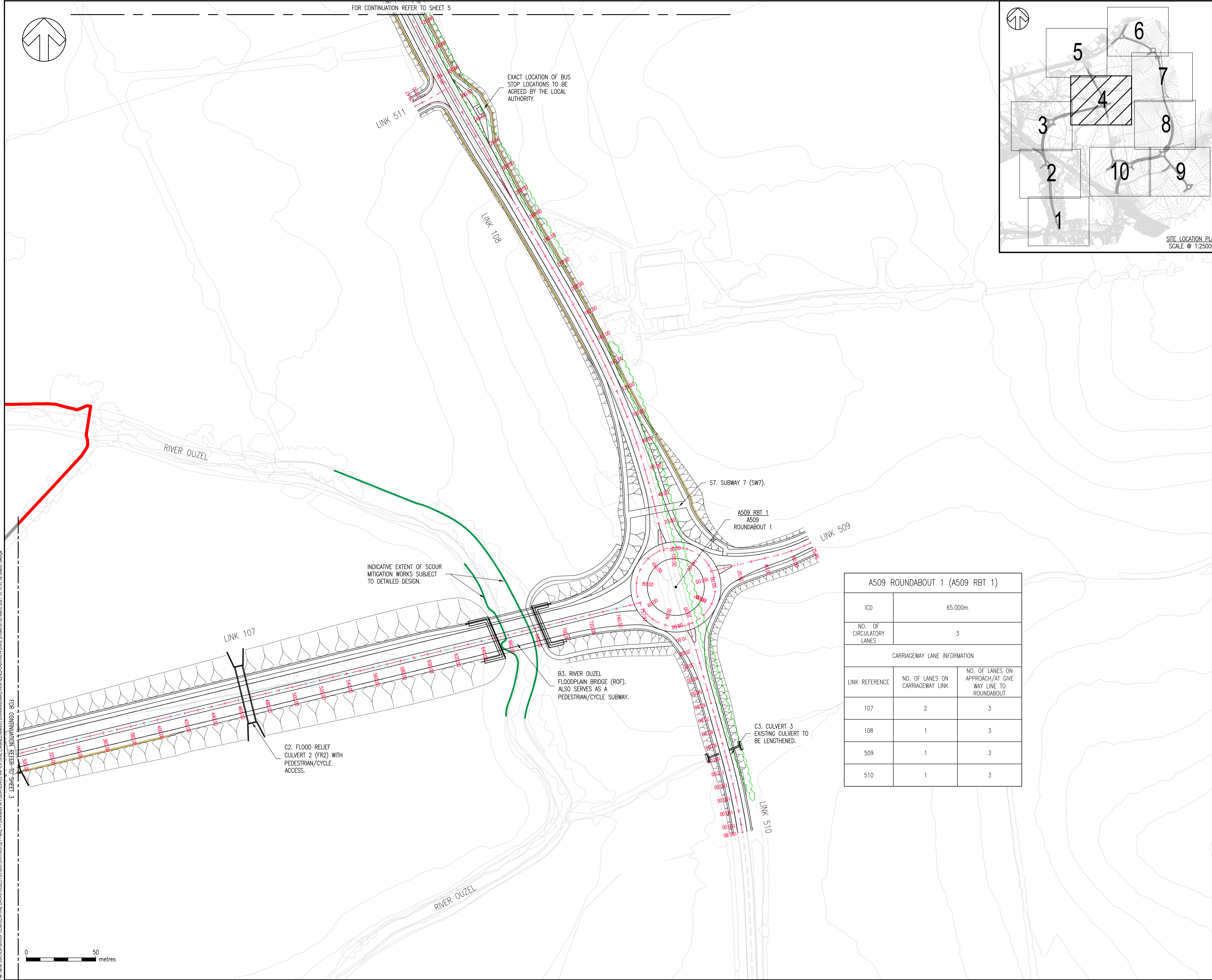

EXACT LOCATION OF BUS STOP LOCATIONS TO BE AGREED BY THE LOCAL AUTHORITY.

LINK 511

LINK 108

S7. SUBWAY 7 (SW7).

A509_RBT_1
A509
ROUNDBOUT 1

LINK 509

LINK 107

C2. FLOOD RELIEF
CULVERT 2 (FR2) WITH
PEDESTRIAN/CYCLE
ACCESS.

B3. RIVER OUZEL
FLOODPLAIN BRIDGE (ROF).
ALSO SERVES AS A
PEDESTRIAN/CYCLE
SUBWAY.

C3. CULVERT 3
EXISTING CULVERT TO
BE LENGTHENED.

LINK 510

RIVER OUZEL

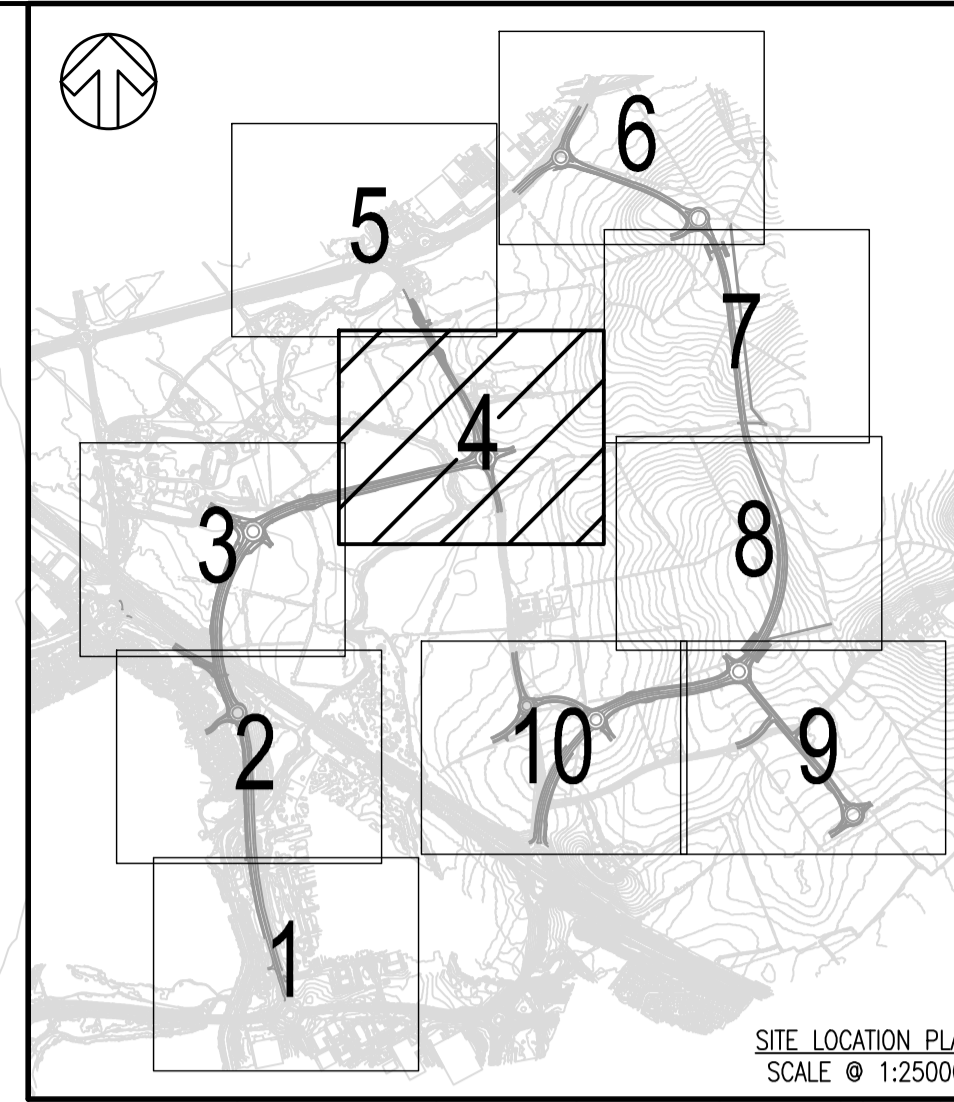

SITE LOCATION PLAN
SCALE @ 1:25000

NOTES:

- DRAWINGS ARE PREPARED TO SUPPORT DETAILED ELEMENT OF HYBRID PLANNING APPLICATION FOR THE STRATEGIC HIGHWAY INFRASTRUCTURE ASSOCIATED WITH MILTON KEYNES EAST (MKE) DEVELOPMENT.
- ALL DIMENSIONS ARE IN METRES UNLESS OTHERWISE STATED.
- THIS DRAWING SHOULD BE READ IN CONJUNCTION WITH ALL RELEVANT DOCUMENTATION, DRAWINGS AND STANDARD DETAILS.
- THIS DRAWING IS NOT TO BE REPRODUCED IN ANY PART OF FORM WITHOUT PRIOR CONSENT FROM WSP UK LIMITED, ALL COPY RIGHT RESERVED.
- CONFLICTING INFORMATION SHOWN ON THE ENGINEER'S DRAWINGS OR DISCREPANCIES BETWEEN THE INFORMATION GIVEN BY THE ENGINEER AND THAT PROVIDED BY OTHERS MUST BE REFERRED TO THE ENGINEER BEFORE THE WORKS COMMENCE.
- THE LIGHTING PROPOSALS SHOWN ARE SUBJECT TO CHANGE FOLLOWING FURTHER DESIGN DEVELOPMENT CONSIDERING SENSITIVE ENVIRONMENTAL CONSTRAINTS AND APPROVAL REQUIREMENTS FROM THE LOCAL AUTHORITY.
- THE MILTON KEYNES HIGHWAY BOUNDARY IS TAKEN FROM INTERACTIVE HIGHWAY BOUNDARY MAPPING FOUND ON THE MILTON KEYNES COUNCIL'S WEBSITE.
- TOPOGRAPHICAL INFORMATION PROVIDED BY MK SURVEYS FILE - "28562" ON THE 11/06/2020 AND 3D ENGINEERING SURVEYS FILE - "DES21007_MKE_REV1" ON THE 22/02/2021. WSP CAN NOT ACCEPT RESPONSIBILITY FOR ANY INACCURACIES.
- ALL REDWAYS DESIGNED IN ACCORDANCE WITH LTN 2/08.
- EARTHWORKS SHOWN OUTSIDE THE TRANSPORTATION CORRIDOR SHALL BE REVIEWED DURING DETAILED DESIGN STAGE WITH A VIEW TO EITHER LOCALLY STEEPEN OR ADJUSTING EXISTING GROUND LEVELS SO THAT ALL WORKS ARE LOCATED WITHIN THE CORRIDOR.

KEY:

- GENERAL**
- PLANNING APPLICATION BOUNDARY
 - HIGHWAYS ENGLAND HIGHWAY BOUNDARY
 - MILTON KEYNES COUNCIL HIGHWAY BOUNDARY
 - PROPOSED TRANSPORTATION CORRIDOR
 - LAND SAFEGUARDED FOR FUTURE TRANSPORTATION CORRIDOR
 - PROPOSED NOISE FENCE
 - EXISTING TREES AND VEGETATION WITHIN EXISTING HIGHWAY BOUNDARY IMPACTED BY THE PROPOSED WORKS (OTHER EXISTING TREES OUTSIDE THE EXISTING HIGHWAY BOUNDARY MAY BE AFFECTED AND FORM OF NOISE BARRIER TO BE DETERMINED DURING DETAILED DESIGN)
 - PROPOSED VEHICLE RESTRAINT SYSTEM (VRS)

UNTIL TECHNICAL APPROVAL HAS BEEN OBTAINED FROM THE RELEVANT LOCAL AUTHORITIES OR STATUTORY BODIES, IT SHOULD BE UNDERSTOOD THAT ALL DRAWINGS ARE ISSUED AS PRELIMINARY AND NOT FOR CONSTRUCTION. SHOULD THE CONTRACTOR AND / OR EMPLOYER COMMENCE WORK PRIOR TO APPROVAL BEING GIVEN, IT IS ENTIRELY AT THEIR OWN RISK

A509 ROUNDBOUT 1 (A509 RBT 1)		
ICD	65.000m	
NO. OF CIRCULATORY LANES	3	
CARRIAGEWAY LANE INFORMATION		
LINK REFERENCE	NO. OF LANES ON CARRIAGEWAY LINK	NO. OF LANES ON APPROACH/AT GIVE WAY LINE TO ROUNDBOUT
107	2	3
108	1	3
509	1	3
510	1	3

REV	DATE	BY	DESCRIPTION	CHK	APP
P03	26/03/2021	GLG	MINOR AMENDMENTS FOR PLANNING	ARP	SAP
P02	12/03/2021	GLG	ISSUED FOR PLANNING	ARP	SAP
P01	15/01/2021	OPL	FIRST ISSUE	ARP	SAP

DRAWING STATUS: S4 - FOR APPROVAL

Grosvenor House, 2 Grosvenor Square, Southampton, SO15 2BE, UK
T+44 (0) 2380 101 700
wsp.com

CLIENT: BERKELEY ST JAMES

ARCHITECT: JTP / STEPHEN GEORGE AND PARTNERS

SITE/PROJECT: MILTON KEYNES EAST

TITLE: GENERAL ARRANGEMENT FOR PLANNING SHEET 4

SCALE @ A1:	CHECKED:	APPROVED:	
1:1250	ARP	SAP	
PROJECT NO:	DESIGNED:	DRAWN:	DATE:
70057521	ARP	GLG	March 21

DRAWING NO: MKE-WSP-ZZ-ZZ-C-DR-0014 REV: P03

© WSP UK Ltd

File name: \\UK.VSPGROUP.COM\CENTRAL_DATA\PROJECTS\00575070057521_MKE_PLANNING_APPLICATIONS\WSP\CIVIL\ENGINEERING\DRAWINGS\MKE-WSP-ZZ-ZZ-C-DR-0014.DWG, printed on: 28 March 2021 10:10:33, by: Galen, George