

File name: I:\UK\WSP\GROUP\COMCENTRAL\DATA\PROJECTS\70057521-1\WSP-PLANNING\APPLICATIONS\DRAWINGS\WSP-ZZ-C-SK-0520-0530.DWG, printed on: 28 March 2021, 12:49:37, by: Philip Lowe, Orlia

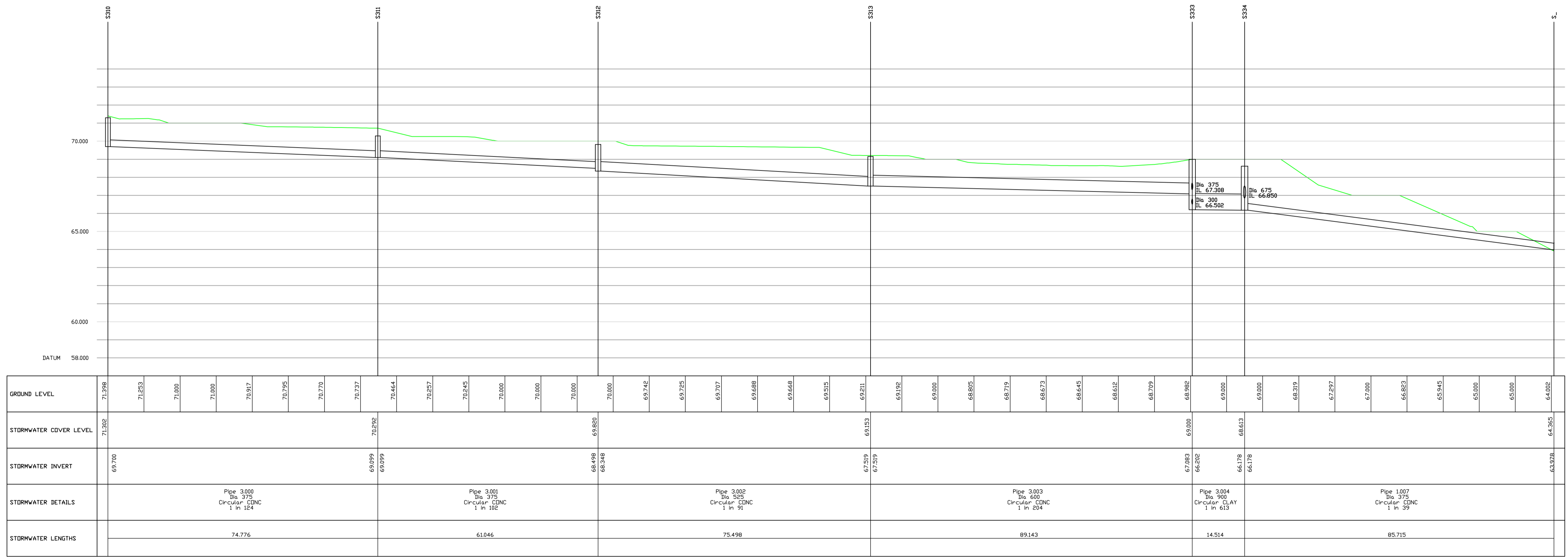
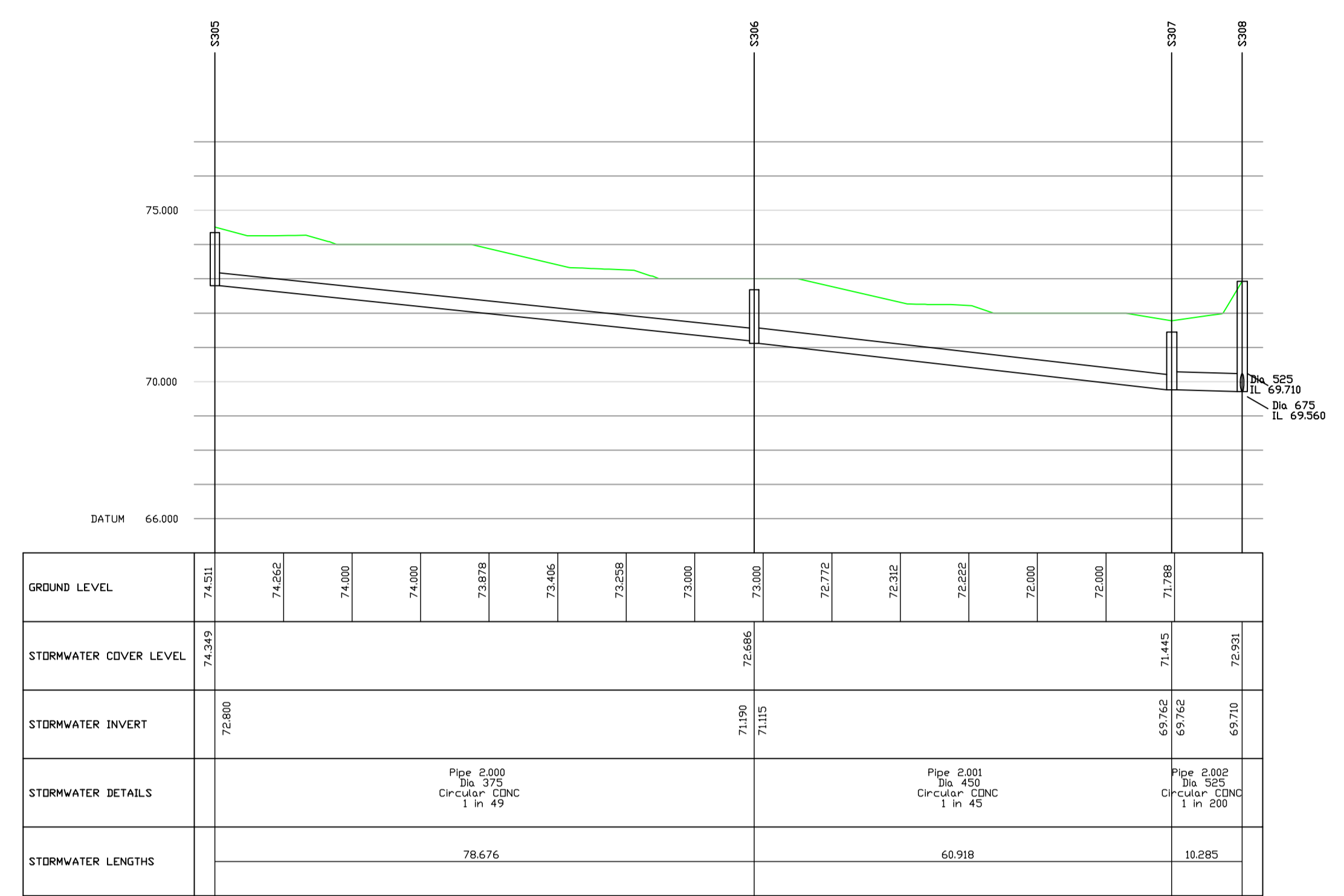

- NOTES**
- THIS DRAWING SHOULD BE READ IN CONJUNCTION WITH ALL RELEVANT DOCUMENTATION, DRAWINGS AND STANDARD DETAILS.
 - THE DESIGN HAS BEEN DEVELOPED & AGREED THROUGH CONSULTATION WITH THE RELEVANT AUTHORITIES (HIGHWAYS, SEWERAGE, PLANNING AND SAB).
 - IN ACCORDANCE WITH THE CDM REGULATIONS RESIDUAL RISKS OF SIGNIFICANCE ARE INDICATED ON THE CA DRAWING ONLY BY MEANS OF A HAZARD TRIANGLE WITH APPROPRIATE NOTE.
 - INFORMATION REGARDING THE LOCATION AND DEPTH OF EXISTING SERVICES CANNOT BE GUARANTEED BY THE STATUTORY UNDERTAKER.
 - THE CONTRACTOR SHALL CONDUCT THE WORKS WITH DUE REGARD TO THE ECOLOGICAL, ENVIRONMENTAL REQUIREMENTS OF THE SCHEME.
 - THE CONTRACTOR SHALL TAKE SUCH STEPS TO SAFEGUARD AGAINST CONTAMINATION OF LOCAL WATERCOURSES.
 - CONFLICTING INFORMATION SHOWN ON THE ENGINEER'S DRAWINGS OR DISCREPANCIES BETWEEN THE INFORMATION GIVEN BY THE ENGINEER AND THAT PROVIDED BY OTHERS MUST BE REFERRED TO THE ENGINEER BEFORE THE WORKS COMMENCE.
 - DIMENSIONS SHOWN ARE IN METRES. DIMENSIONS MARKED 'DIMENSIONS TO BE SITE CHECKED' ARE SUBJECT TO CONFIRMATION BY THE CONTRACTOR BEFORE THE WORKS COMMENCE.

PO1	10/03/2021	DSF	FIRST ISSUE		BU	SP
REV	DATE	BY	DESCRIPTION		CHK	APP

DRAWING STATUS:



CLIENT: BERKELEY ST JAMES

ARCHITECT: JTP / STEPHEN GEORGE AND PARTNERS

SITE/PROJECT: MILTON KEYNES EAST

TITLE: DRAINAGE LONG SECTION SHEET 10

SCALE @ A1:	Custom	CHECKED:	BU	APPROVED:	SP
PROJECT NO:	70057521	DESIGNED:	DSF	DRAWN:	DSF
				DATE:	March 21

DRAWING NO:	MKE-WSP-ZZ-C-SK-0520-0530	REV:	P01
-------------	---------------------------	------	-----

THIS PROVISIONAL PRELIMINARY DESIGN IS FOR GUIDANCE PURPOSES ONLY. WSP ACCEPTS NO LIABILITY FOR ANY DAMAGE, LOSS, EXPENSES OR COST INCURRED AS A RESULT OF RELYING ON THE INFORMATION PROVIDED IN THE DESIGN APPRAISAL ESTIMATE. THE APPRAISAL ESTIMATE WAS DERIVED FROM A MIXTURE OF THIRD PARTY INFORMATION AND THE APPLICATION OF WSP'S REASONABLE SKILL AND CARE, BUT MAY BE SUBJECT TO OTHER SUCH INFORMATION AND VARIATIONS OF WHICH WSP IS UNAWARE. THE DESIGN APPRAISAL ESTIMATE SHOULD NOT BE RELIED UPON FOR TENDER OR PROCUREMENT PURPOSES. FOR ACCURATE ADVICE A DETAILED DESIGN SHOULD BE CARRIED OUT AT THE APPROPRIATE DESIGN STAGE. THEREFORE, USE OF THE INFORMATION IS ENTIRELY AT YOUR OWN RISK.